

GRACE COTTAGE FAMILY HEALTH & HOSPITAL EMERGENCY DEPARTMENT UPGRADE

An expansion and renovation of the Emergency Department entrance and patient intake area is underway for improved patient flow, privacy, comfort, and security.

Emergency services will continue uninterrupted during construction.

The temporary entrance is the Nessel Porch (side of building, before the existing Emergency entrance.)

The red box below indicates the existing ED space. A new feature of the 17x42-foot addition is the covered portico for ambulances to pull in under cover with **covered ambulance entrance**, protecting patients from the weather.

There will be a separate entrance for **walk-in patients** with a private, comfortable **check-in station**, allowing for private conversation between patient and registration clerk. They will have access to a nearby **restroom** and can wait for treatment in a private **waiting room**.

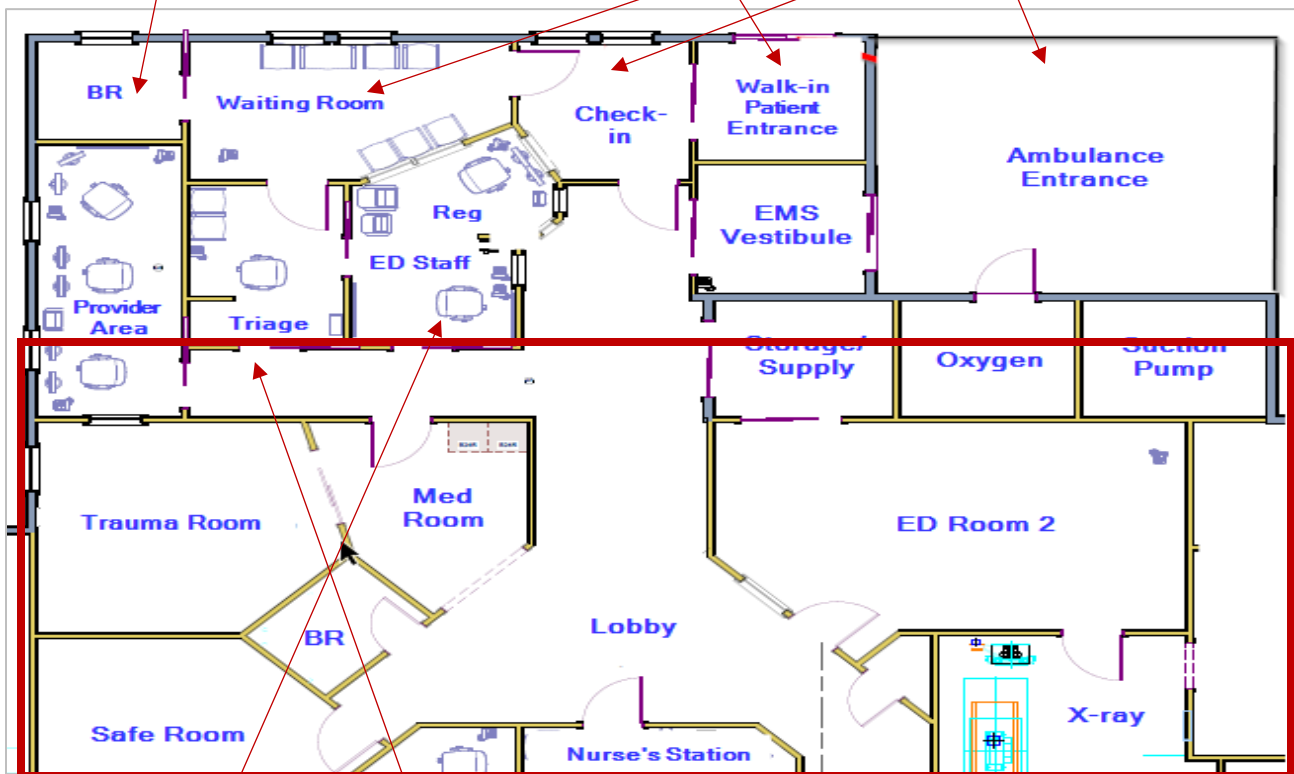

The new space will include a **Triage Room** for initial assessment and to treat minor issues. This leaves the specially equipped treatment and trauma rooms ready for more severe issues.

The expanded ED will have space specifically dedicated for the presence of a 7-night-a-week **overnight security officer**.